

Restaurant Space Near Public Square

For Lease | 230 Euclid Avenue, Cleveland, Ohio 44114



230 Euclid Avenue

- 1,400 SF former restaurant located in the center of downtown Cleveland, steps away from Public Square, the new Sherwin Williams HQ, the Gateway District, and the Warehouse District
- Located just off of East 4th Street, Cleveland's premier location for the regions top bars and restaurants
- Spaces comes equipped with walk-in cooler/freezer, 3 compartment sink, condensate hood system and other restaurant infrastructure
- Highly visible location with an abundant office and residential population in the immediate area
- Nearby tenants include The House of Blues, Chipotle, Naf Naf Grill, The Corner Alley, Cordelia, Marble Room Steaks and Raw Bar & many more

Lease Rate: Contact Broker



Availability

UNIT	SIZE
1	1,400 SF

Quick Stats

Building SF	19,771 SF
Year Built	1915
Land Area	0.45 Acres

Floor Plan | First Floor

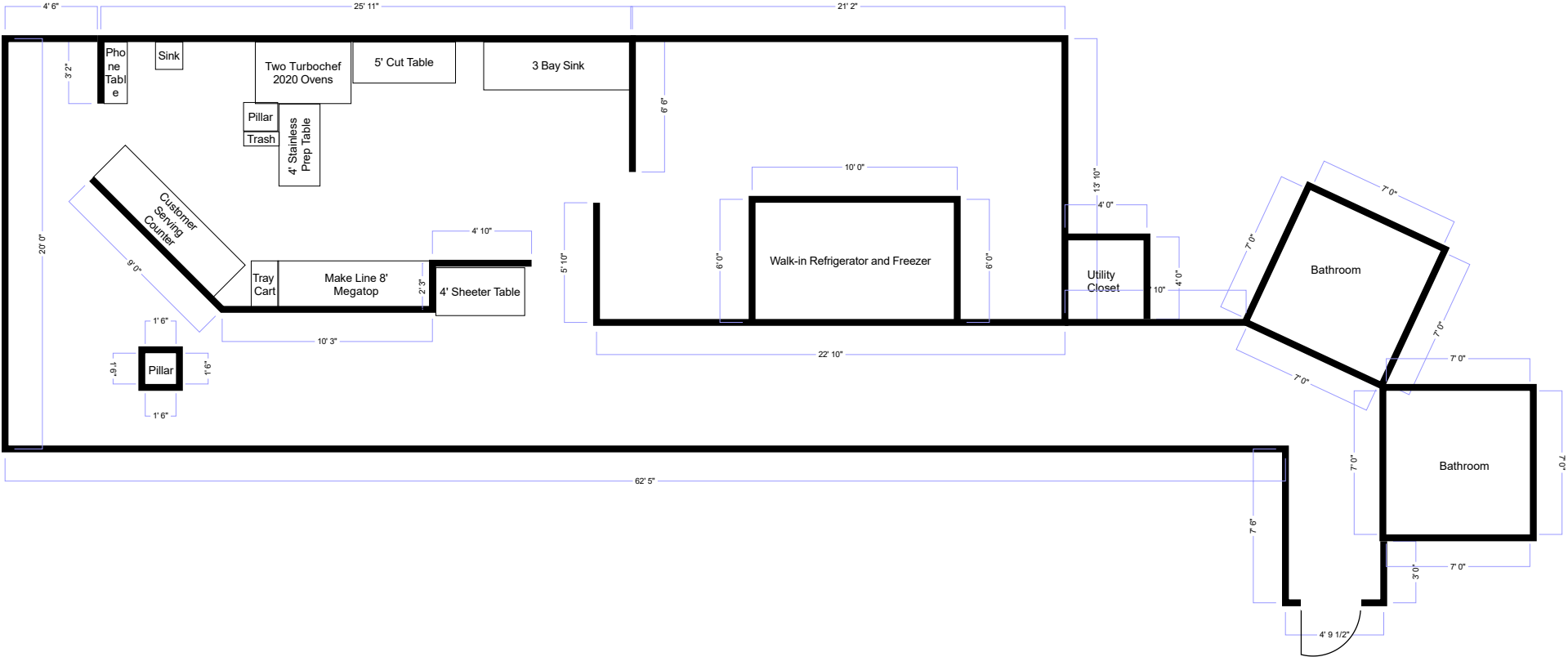



86,382
Population
(3 Mile)

32.9
Median Age
(3 Mile)

42,069
Households
(3 Mile)

\$74,707
Household Income
(3 Mile)

6,849
Businesses
(3 Mile)

110,447
Employees
(3 Mile)

**230 EUCLID AVENUE
CLEVELAND, OHIO 44114**

CAMERON CALLAHAN
Senior Associate
ccallahan@crescorealestate.com
+1 216 232 4101

ALEX SMITH
Vice President
asmith@crescorealestate.com
+1 216 525 1476



Cushman & Wakefield | CRESCO
6100 Rockside Woods Blvd, Suite 200
Cleveland, Ohio 44131

crescorealestate.com

Your Logo Here

OTAMI NOODLE

234 Euclid